

THIS DEED OF AGREEMENT is made the 5 day of May  
One thousand nine hundred and eighty one (1981)  
BETWEEN THE ROMAN CATHOLIC BISHOP OF THE DIOCESE OF  
AUCKLAND a "Corporation Sole" (hereinafter  
with his successors referred to as "the Proprietor")  
of the first part  
and HER MAJESTY THE QUEEN acting by and through the  
Minister of Education (hereinafter referred to as  
"the Minister") of the second part

WHEREAS

- A The Proprietor is the owner of  
St. Joseph's School, ONEHUNGA  
(hereinafter referred to as "the School")
- B The School is a Roman Catholic Primary School for boys from  
new entrants to Standard four and for girls from new entrants  
to Form two offering Education with a Special Character.
- C The School was established in 1915 and up to the  
effective date of integration was in part staffed  
by members of the Roman Catholic Religious Order  
of Women, known as the Sisters of Mercy. The  
said Order will continue after the effective date  
of integration to offer teaching staff to the School,  
so long as it has members available for that purpose.
- D The Minister and the Proprietor have agreed to enter  
into this Deed of Agreement pursuant to the Private  
Schools Conditional Integration Act 1975, whereby the  
School is to be established as an integrated school.

NOW THIS DEED OF AGREEMENT WITNESSETH THAT IT IS HEREBY  
COVENANTED AGREED AND DECLARED BY AND BETWEEN THE PARTIES  
HERETO AS FOLLOWS :-

1. THAT the Minister and the Proprietor HEREBY AGREE that  
the School is to become an integrated School pursuant to  
the Private Schools Conditional Integration Act 1975.

\* J.M.  

2. THE School's Special Character as is hereinafter described, shall incorporate the Education with a Spécial Character as provided in the School AND IT IS HEREBY AGREED AND DECLARED that the School shall at all times in the future be conducted and operated so as to maintain and preserve the School's Special Character and these presents shall be interpreted so as to maintain and preserve the Spécial Character of the School.

3. ON behalf of the Proprietor it is hereby agreed that:

- (a) The Proprietor is the owner of all the land and improvements more particularly described in the First Schedule hereto (hereinafter referred to as "the Proprietor's land") and of which for the purposes of this Deed of Agreement, the School premises form part only. The School premises for the purposes of this Deed of Agreement being the land and improvements more particularly described in the Second Schedule hereto (hereinafter referred to as "the School premises").
- (b) The Proprietor shall set apart and appropriate as owner all the School premises and all the chattels and other assets of the Proprietor associated with the School exclusively for the purposes of the School as an integrated School, so that the Controlling Authority of the School shall have the exclusive right to the possession and use of the School premises and chattels

- PROVIDED THAT -

+ J.M.  

- (i) At the request of the Proprietor, the School Committee may grant the use of the School premises and chattels to the Proprietor or other person or persons at any time when the School premises and chattels are not required for school purposes and the School Committee shall not unreasonably or arbitrarily withhold its consent. The School Committee may require the Proprietor or other person or persons to pay a reasonable fee to the School Committee as a condition of such use.
- (ii) With the consent of the Proprietor, the School Committee may grant the use of the School premises and chattels to other person or persons at any time when the School premises and chattels are not required for School purposes and the Proprietor shall not unreasonably or arbitrarily withhold his consent. The School Committee may require any such person or persons to pay a reasonable fee to the School Committee as a condition of such use.
- (c) The Proprietor shall accept and meet the liability for all mortgages, liens and other charges upon the land and buildings comprising the School premises.
- (d) The Proprietor shall plan, pay for, and execute the improvements described in the Third Schedule hereto, to the School premises so as to bring the School buildings and associated facilities forming

+ J.M.  

part of the School premises up to the minimum standard for comparable State Schools prevailing at the effective date of this Deed of Agreement. Such improvements to be carried out in accordance with the dates specified against such improvements in the Third Schedule hereto. The proprietor shall upon completion of any improvements to electrical services described in the Third Schedule hereto arrange for the local Electrical Supply Authority to inspect the School premises in terms of Regulation 45 of the Electrical Supply Regulations 1976.

- (e) The Proprietor shall plan, execute and pay for such capital works and associated facilities at the School as may be approved or required, from time to time, by the Minister pursuant to Section 40 (2) (d) of the Private Schools Conditional Integration Act 1975.
- (f) The Proprietor may own or hold upon trust, and control and maintain, any land, buildings and associated facilities that, although not part of the integrated School premises in terms of this Deed of Agreement are regarded by the Proprietor as appropriate to maintain the Special Character of the School.
- (g) The Proprietor shall insure all the buildings forming part of the School premises and the Proprietor's chattels (if any) owned or held upon trust for the purposes of the School and the other assets owned by the Proprietor for the purposes of the School against risks

+J.M.  
9

normally insured against, in some responsible insurance office in New Zealand, and further acknowledges the obligation on him created by Section 40 (2) (h) of the Private Schools Conditional Integration Act 1975.

- (h) No person employed at the School and paid for his services in whole or in part out of moneys appropriated by Parliament, shall be paid by the Proprietor or his servants or agents any remuneration additional to that provided for by the Private Schools Conditional Integration Act 1975 or shall be granted or permitted any condition of service more favourable than that permitted in the case of a person employed in a comparable position in a State School PROVIDED HOWEVER that a teacher to whom the provisions of Section 71 of the Private Schools Conditional Integration Act 1975 apply, shall continue to be paid no less than the same salary, and be accorded the same status, as he received or was accorded on the day before the effective date of the integration of the School.

4. THE land and buildings constituting the School premises are subject to the mortgages, debts, liens, encumbrances, easements, licences, restrictions and other matters which affect the title to or enjoyment of the land and have the appurtenances or benefits attaching to the land more particularly described in the First Schedule hereto.

+ J.M.  

5. THE Special Character of the School is that it is a Roman Catholic School for boys and girls established by the Roman Catholic Bishop of the Diocese of Auckland, New Zealand, for the Roman Catholic Community of the Diocese of Auckland, which promotes and supports the School and of which the School is part, to provide and to continue to provide Education with a Special Character, that is to say :

The School is a Roman Catholic School in which the whole School community through the general School programme and in its Religious instructions and observances, exercises the right to live and teach the values of Jesus Christ. These values are as expressed in the Scriptures and in the practices, worship and doctrine of the Roman Catholic Church, as determined from time to time by the Roman Catholic Bishop of the Diocese of Auckland.

6. THE Proprietor of the School subject to the provisions of this Deed of Agreement :

- (a) Shall continue to have the responsibility to supervise the maintenance and preservation of the Education with a Special Character provided by the School;
- (b) Shall continue to have the right to determine from time to time what is necessary to preserve and safeguard the Special Character of the Education provided by the School and described in this Deed of Agreement;

+ J.M.



- (c) May invoke the powers conferred upon him by the Private Schools Conditional Integration Act 1975, if in the opinion of the Proprietor the Special Character of the School as defined and described in this Deed of Agreement has been or is likely to be jeopardised or the Education with a Special Character provided by the School as defined and described in this Deed of Agreement is no longer preserved and safeguarded.

7. (a) THE Controlling Authority of the School shall be the Education Board of the Auckland Education District as constituted pursuant to Section 15 of the Education Act 1964.

- (b) The School shall be managed by a School Committee constituted pursuant to the provisions of Section 26 of the Private Schools Conditional Integration Act 1975. The School Committee shall consist of:

- (i) One (1) member to be appointed by the Proprietor of the School;
- (ii) Eight (8) members to be elected by the parents of children attending the School PROVIDED HOWEVER that in the event of the School roll altering at any time then the number of such members shall be fixed by ascertaining the number of members that a State School Committee would have, based on the current School roll in accordance with the provi-

+ J.M.  

sions of the School Committees Administration Regulations 1965 and subtracting one from that number.

- (c) Any election conducted pursuant to Section 26 of the Private Schools Conditional Integration Act 1975 shall be conducted as nearly as possible in the manner prescribed by the School Committees Administration Regulations 1965 and any regulations made in amendment thereof or in substitution therefor and the provisions of those regulations shall, with any necessary modifications, be applied accordingly.
- (d) The control and management of the School shall be exercised subject to the provisions of Section 25 (6) of the Private Schools Conditional Integration Act 1975.

8. THE School had a roll of two hundred and sixty seven (267) pupils as at the 30th September 1980 being the year when the roll figures were last compiled. It is agreed by and between the parties hereto that the maximum roll of the School shall be two hundred and seventy (270) pupils.

9. THE Proprietor agrees that pursuant to Paragraph (d) and (e) of Clause 3 of this Deed of Agreement he will bring the School up to the minimum standard of accommodation laid down from time to time by the Director-General for a comparable State School.

+ J.M.





10. (a) PREFERENCE of enrolment at the School under Section 29 (1) of the Private Schools Conditional Integration Act 1975 shall be given only to those children whose parents have established a particular or general religious connection with the Special Character of the School and the Controlling Authority shall not give preference of enrolment to the parents of any child unless the Proprietor has stated that those parents have established such a particular or general religious connection with the Special Character of the School.

(b) In accordance with Section 7 (6) (h) of the Private Schools Conditional Integration Act 1975, unless the Proprietor and the Controlling Authority otherwise agree and subject to places being available, the number of pupils whose parents do not have a preference of enrolment at the School in accordance with the provisions of Section 29 (1) of the Private Schools Conditional Integration Act 1975 shall be limited at all times to fourteen (14) pupils out of the total roll of the School and the Controlling Authority shall not enrol more than that number PROVIDED THAT to maintain and preserve the Special Character of the School the Controlling Authority in classifying such pupils so enrolled shall endeavour to reasonably distribute them through the range of classes offered by the School.

(c) Wherever any difficulty arises related to enrolment at

+ J.M.  

the School in terms of Section 54 of the Private Schools Conditional Integration Act 1975, it may be referred to the Controlling Authority of the School pursuant to the provisions of the said section.

11. IT is agreed by and between the parties hereto that as Religious observances and Religious instruction form part of the Education with a Special Character provided by the School, Religious observances and Religious instruction in accordance with the determination made from time to time by the Roman Catholic Bishop of the Diocese of Auckland shall continue to form part of the School programme in accordance with Sections 31 and 32 of the Private Schools Conditional Integration Act 1975.

12. THE Proprietor, together with his servants, agents and licensees shall, subject to the proviso to Section 40 (2) (i) of the Private Schools Conditional Integration Act 1975, have at all reasonable times access to the School to ensure that the Special Character of the School is being maintained.

13. THE Proprietor, together with his servants, agents and licensees, shall have at all reasonable times access to the land and buildings of the School constituting the School premises sufficient to enable him to exercise the powers and carry out the responsibilities vested in him and imposed on him by the Private Schools Conditional Integration Act 1975 and by this Deed of Agreement.

+ J.M.  

14. AN advertisement for the position of Principal of the School shall in accordance with Section 65 (1) (a) of the Private Schools Conditional Integration Act 1975 state that a willingness and ability to take part in Religious instruction appropriate to the Special Character of the School shall be a condition of appointment. Any person so appointed to the position of Principal shall accept these requirements as a condition of appointment. The Principal so appointed shall accept and recognise a responsibility to maintain and preserve the Special Character of the School.

15. THERE shall be a position of responsibility at the School to be designated Director of Religious Studies in accordance with Section 65 (1) (b) of the Private Schools Conditional Integration Act 1975, which position shall be part of the normal staffing entitlement of the School as established by Regulations made under the Education Act 1964 and an advertisement for that position shall state that a willingness and ability to take part in Religious instruction appropriate to the Special Character of the School shall be a condition of appointment. Any person so appointed to the position of Director of Religious Studies shall accept these requirements as a condition of appointment. The Director of Religious Studies shall give guidance and provide effective leadership in Religious instruction and observances throughout the School PROVIDED HOWEVER that in the event of the staffing entitlement of the School altering at any time during the currency of this Deed

+ J.M.  

of Agreement then the position of Director of Religious Studies shall be determined in accordance with the then current staffing entitlement of the School under the Education Act 1964 and Regulations made thereunder and as is more particularly described in the Fourth Schedule hereto.

16. A person appointed as aforesaid to the position of Director of Religious Studies at the School shall undertake such teaching duties, if any, as may be required by the Principal of the School.

17. THERE shall be a position at the School to be designated as Senior Teacher Junior Classes in accordance with Section 65 (1) (d) of the Private Schools Conditional Integration Act 1975 and the Controlling Authority of the School in advertising the position of Senior Teacher Junior Classes shall state that a willingness and ability to take part in Religious instruction appropriate to the Special Character of the School shall be a condition of appointment. Any person so appointed to the position of Senior Teacher Junior Classes shall accept these requirements as a condition of appointment PROVIDED HOWEVER that in the event of the staffing entitlement of the School altering at any time during the currency of this Deed of Agreement then the position of Senior Teacher Junior Classes shall be determined in accordance with the then current staffing entitlement of the School under the Education Act 1964 and Regulations made thereunder and as is more particularly described in the Fourth Schedule hereto.

+ J.M.  
D

18. THERE shall be two (2) other teaching positions at the School which in accordance with Section 65 (1) (c) of the Private Schools Conditional Integration Act 1975, shall be positions of importance carrying a responsibility for Religious instruction and an advertisement for those positions shall state that a willingness and ability to take part in Religious instruction appropriate to the Special Character of the School shall be a condition of appointment. Any person so appointed to these positions shall accept these requirements as a condition of appointment PROVIDED HOWEVER that in the event of the staffing entitlement of the School altering at any time during the currency of this Deed of Agreement then the number of teaching positions designated under Section 65 (1) (c) of the Private Schools Conditional Integration Act 1975 as positions of importance carrying a responsibility for Religious instruction shall be determined in accordance with the then current staffing entitlement of the School under the Education Act 1964 and Regulations made thereunder and as is more particularly described in the Fourth Schedule hereto.

19. THE position of Deputy Principal at the School is agreed pursuant to Section 66 of the Private Schools Conditional Integration Act 1975 to be a special position that requires particular capabilities in the teacher appointed, namely to assist in planning and organising the courses and programmes

+ J.M.  
D

at the School to ensure that they reflect the Special Character of the School and an advertisement for the position of Deputy Principal shall state that possession of these capabilities shall be a condition of appointment. Any person so appointed to the position of Deputy Principal shall accept these requirements as a condition of appointment.

20. THE Proprietor may with the consent of the Controlling Authority in accordance with Section 69 (1) of the Private Schools Conditional Integration Act 1975 arrange for any retired teacher to undertake voluntary tasks to assist in the School with the teaching of Religious observances and Religious instruction appropriate to the Special character of the School.

21. IT is agreed by and between the parties hereto that as Religious observances and Religious instruction form part of the Education with a Special Character provided by the School the Proprietor may employ any person as a Chaplain or otherwise, for the purposes of Religious observances or instruction and the provisions of Section 69 (2) and (3) of the Private Schools Conditional Integration Act 1975 shall apply.

22. THE Proprietor of the School shall have the right to enter into an Agreement with the parents or other persons accepting responsibility for the education of a child pro-

+ J.M.  
S

viding that, as a condition of enrolment and attendance of that child at the School, the parents or other persons shall pay attendance dues established in respect of the School or group of Integrated Schools owned by the Proprietor or Proprietors of other Roman Catholic Integrated Schools at such rates and subject to such conditions as may be approved from time to time by the Minister, by notice in the New Zealand Gazette in accordance with Section 36 of the Private Schools Conditional Integration Act 1975.

23. THE School is a Primary School for boys from new entrants to standard four and for girls from new entrants to form two and shall remain so until such time as an agreement to a change in this organisation of the School is reached between the Proprietor and the Minister and the parties hereto enter into a supplementary Deed of Agreement to give effect thereto.

24. WHERE any of the costs associated with the conduct of the Proprietor's land that is not part of the School premises cannot be separated from the costs associated with the operation of the School premises, the Proprietor and the school Committee and/or the Controlling Authority shall contribute to such costs according to their respective use of the services and facilities.

25. IT is acknowledged by and between the parties hereto pursuant to Clause 24 hereof that the sewerage service on and serving the Proprietor's land is used in common for

+ J. M.  

the purpose of the School premises and as is more particularly delineated on the plan forming part of the Second Schedule and the cost of maintaining that service shall be apportioned as provided in Clause 24 hereof. Where sewerage or other such services or facilities are wholly or partly situated outside the School premises the Proprietor will continue to make such services or facilities available to the School premises.

26. THE Proprietor shall not engage any teachers between the date of execution of this Deed of Agreement and the effective date of integration other than those whose names have already been notified by the Proprietor to the Director-General of Education without first obtaining the consent of the Director-General

27. THE Proprietor shall reimburse the Minister for the payment of salary, wages and proportion of holiday pay due and paid by the Minister in respect of the 1981 School year to any person employed at the School up to the effective date of integration.

28. THE Proprietor will demolish Blocks A and E (as shown on the plan attached to the Second Schedule) and will replace these buildings with the classroom and toilet blocks specified in the Third Schedule. The new blocks are to be completed to Ministry of Works and Development standards for a comparable state school by 31 March 1983. Until the new blocks are so completed neither the Minister nor the Controlling Authority will be responsible for the maintenance of Blocks A or E and the Proprietor will carry out maintenance to a reasonable

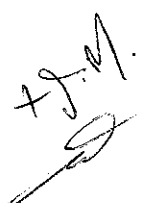



standard on Blocks A and E until each block is demolished.

29. NOTWITHSTANDING Clause 31 hereof the Proprietor and the Controlling Authority will share the cost of exterior and interior maintenance of the school's gymnasium and hall (Block D) in the following proportions, the Proprietor will pay one third and the Controlling Authority two thirds of such costs.

30. THE Minister shall be responsible only for the normal maintenance of the retaining walls on the School premises and all other expenditure in respect of the retaining walls on the School premises shall be the responsibility of the Proprietor.

31. THE Minister shall subject to Clause 3(d), (e), 28 and 29 of this Deed of Agreement after the effective date hereof maintain the School premises and the associated facilities in a state of repair order and condition as for a comparable State School under the same Controlling Authority and provide for the maintenance of the chattels as though the School were a State School. The School shall be entitled to such furniture and equipment as the Controlling Authority supplies from time to time to comparable State Schools.

32. THE effective date of this Deed of Agreement shall be the 25th day of May 1981.

33. ON and after the effective date specified in this Deed of Agreement the School shall be an integrated school in terms of the Private Schools Conditional Integration Act 1975.

IN WITNESS WHEREOF these presents have been executed the day and year first hereinbefore written. *+ J.M.*

SIGNED by JOHN MACKEY THE ROMAN  
CATHOLIC BISHOP OF THE DIOCESE  
OF AUCKLAND and sealed with his  
Seal of Office in the presence  
of:

*John Mackey*

*Maria Josephine Figg*  
*St. Mary's Convent*  
*Wellington*

SIGNED FOR AND ON BEHALF OF HER MAJESTY  
THE QUEEN by MERVYN LANGLOIS WELLINGTON  
Minister of Education in the presence  
of:

*Mervyn Langlois*

*M. J. Fetter*  
*Private Secretary*

*12 Hohiria Road*  
*Hataitai*  
*Wellington, 3*

FIRST SCHEDULE.

Description of total land buildings and other improvements comprising the Proprietor's land of which the School premises form part

THE PROPRIETOR'S LAND All that Land, School Buildings and other improvements owned by the Roman Catholic Bishop of the Diocese of Auckland, situate at Church Street, Onehunga, Auckland, New Zealand, being known as St. Joseph's Primary School, Onehunga, and being more particularly described as follows :-

All that Freehold parcel of land delineated in green on the annexed plan containing 1.2137 hectares more or less being Lot 1 Deposited Plan 89948 and being formerly Allotments 1 and 3 and part Allotments 2 and 4 Section 14 Village of Onehunga, and being all the land in Certificate of Title Volume 478 folio 125. <sup>North</sup> (Auckland Registry)

SUBJECT TO :

Caveat against part formerly in C.T. 540/57 by the District Land Registrar 31.7.1931.

There is a debt owing to the Diocesan Development Fund of the Roman Catholic Diocese of Auckland.

+ J.M.



SECOND SCHEDULE

Description of land buildings and other improvements comprising the School premises

THE SCHOOL PREMISES

All that part of the Proprietor's land as described in the First Schedule hereto, delineated in red on the annexed plan of the Proprietor's land, which plan forms part of this Schedule TOGETHER WITH all the School buildings and other improvements thereon.

+ J.M.



ST JOSEPHS SCHOOL, ONEHUNGA

THIRD SCHEDULE

WORKS TO BE CARRIED OUT BY THE PROPRIETOR IN RELATION TO THE INTEGRATED SCHOOL

These works are to be planned, executed and paid for by the Proprietor subject to the provisions of this schedule in relation to the buildings and associated facilities to bring them up to the minimum standard for a comparable state school.

In those cases where the words "half cost to be met by education board" appear in relation to particular works, the buildings supervisor of the Auckland Education Board shall draw up the specifications for such particular works and the proprietor shall obtain his approval to the contractor and to the price before commencing such works. All work is to be carried out by competent tradesmen or in a workman-like manner to the Auckland Education Board standards.

AGREED PHASING OF WORK TO BE COMPLETED BY

SITE	25.5.81	31.3.82	31.3.83	31.3.84	31.3.85	31.3.86
<u>Fencing</u> Erect fence south of Block G (north of field) Erect boundary fence to south and east of Block C up to the end of Block D Erect protective fence along south edge of field Repair stone wall on Galway Street frontage Repair stone wall on part of east boundary		x			x	x
<u>Gates</u> Replace main entrance gate Repair wrought iron gate in stone wall on Galway Street frontage		x			x	x
<u>Access and Parking</u> Form new carpark at main entrance between Block A and Church Street Repair damaged path at the west end of Block A				x x		
<u>Paved Areas</u> Court between Blocks A and D Repair shattered concrete at west end of court Reposition netball sockets so that the new steps to Block B do not intrude onto the court area Courts between Blocks E and F Provide stormwater drainage Provide more wires to fence to prolong mesh life		x		x	+ f m	x

AGREED PHASING OF WORK TO BE COMPLETED BY

	25.5.81	31.3.82	31.3.83	31.3.84	31.3.85	31.3.86
<u>SITE (continued)</u> <u>Playing Field</u> Fill in depressions in playing field and grass around Block C						
<u>Incinerator</u> Replace incinerator with proprietary incinerator complete with flue to Auckland Education Board standards						
<u>Exterior Seating</u> Provide exterior seating to bring total to 300mm exterior seating for each pupil attending the school		x				
<u>Drinking Points</u> Replace 3 existing drinking points with 5 of an approved type			x			
<u>BLOCK A</u> <u>Structural</u> Replace entire block		x				
<u>Fire Protection</u> Install alternative egress from doors in each of of the classrooms (areas 1-5) in the block	x					
<u>BLOCK B</u> <u>Interior</u> Reglaze doors and sidelights using wired glass in all areas used by pupils			x			
<u>Mechanical</u> Provide timeswitch and thermostat control to all heaters existing and recommended in this block (except Area 19) Install 1x1 kw radiant or fan heater manually switched or on a separate circuit to sick bay						

x

22

+ J. M.



AGREED PHASING OF WORK TO BE COMPLETED BY

	25.5.81	31.3.82	31.3.83	31.3.84	31.3.85	31.3.86
<b>BLOCK C Interior (continued)</b>						
Area 7						
Replace door to store 40						
Repair cupboards						
Redecorate						
Provide carpet tiles on floor	x					
Area 8	x					
Repair roof leak at far end of classroom						
Provide carpet tiles on floor	x					
Redecorate (Half cost to be met by education board)	x					
Area 39						
Redecorate						
Replace rusted louvre fittings						
Area 42						
Redecorate						
Provide door check to exterior door						
Area 43						
Provide door check to exterior door						
Replace classroom door						
Redecorate						
Area 44						
Provide door check to exterior door						
Repair exterior door						
Redecorate						
<b>Mechanical</b>						
Provide additional 2kw wall or ceiling mounted radiant heaters to each of areas 6, 7 and 8						
Provide timeswitch and thermostat control to all heaters, existing and new						
<b>Electrical</b>						
Completely upgrade lighting throughout block to state school standards						
Upgrade lighting circuit wiring						



## ACREED PHASING OF WORK TO BE COMPLETED BY

	25.5.81	31.3.82	31.3.83	31.3.84	31.3.85	31.3.86
BLOCK C (continued)						
Fire Protection						
Install alternative egress by means of a communicating door between classroom 6 and the entry foyer of classroom 7, and in the partition wall between classroom 7 and 8	x					
BLOCK D						
Exterior						
Repair flashings to lean-to roof, south side		x				
Repair window on gable end		x				
Replace windows with aluminium frame windows		x				
Resheath all walls in fibrolite		x				
Repaint		x				
Reroof with corrugated iron; provide netting and building paper		x				
Interior						
Area 24						
Complete linings to PE store room		x				
Provide ceiling		x				
Area 25						
Repair water heater		x				
Repair servery doors		x				
Finish off bench top to wall		x				
Repair louvre windows		x				
Repair roof leak		x				
Redecorate					x	
Area 26						
Repair floor and sand and reseal with polyurethane						
Secure wall panels and repair south wall		x				
Provide ceilings to flat roof areas		x				
Redecorate		x				
Area 27						
Repair ceiling						
Redecorate		x				
Provide new floor coverings		x				

AGREED PHASING OF WORK TO BE COMPLETED BY

	25.5.81	31.3.82	31.3.83	31.3.84	31.3.85	31.3.86
<b>BLOCK D Interior (continued)</b>						
Area 27 (continued)						
Provide door furniture, install door check and sign to door						
Area 28						
Repair ceiling and complete trims		x				
Redecorate		x				
Area 29						
Repair ceiling and leak		x				
Sand floor and reseal with polyurethane		x				
Area 30						
Completely upgrade room		x				
Provide door furniture, door check, and door sign		x				
<b>Structural</b>						
Investigate the stability of the block panel in west wall and if necessary remove and frame up in timber covered with suitable cladding						
<b>Mechanical</b>						
Provide timeswitch and thermostat control to all heaters existing and new		x				
Provide an additional 11kw of radiant electric heating to area 26		x				
Upgrade heat insulation throughout the block		x				
Upgrade mounting and wiring termination of radiant infra-red heaters		x				
<b>Electrical</b>						
Replace distribution board with metal clad cabinet type		x				
Upgrade earthing		x				
Upgrade lighting to state school standards - all areas		x				
Provide new wiring as required with earth continuity conductor to reflector type fluorescent fittings		x				

+ J.M.

AGREED PHASING OF WORK TO BE COMPLETED BY

	25.5.81	31.3.82	31.3.83	31.3.84	31.3.85	31.3.86
<p><b>BLOCK D Electrical (continued)</b></p> <p>Replace broken socket outlets throughout block Terminate or remove redundant circuit wiring</p> <p><u>Fire Protection</u></p> <p>Egress</p> <p>Convert the centre set of sliding doors, area 26 to a set of 1.52m double hung outward opening door fitted with panic bolt hardware</p> <p>Install an approved locking device on main entry doors</p> <p>Provide signs indicating position of existing doors</p> <p>Fire Equipment</p> <p>Provide one hose reel in the block</p>		x x				
<p><b>BLOCK E</b></p> <p><u>Structural</u></p> <p>Investigate end block walls and if necessary remove them and frame up in timber covered with suitable cladding</p>	x x x	x				
<p><b>FIRE PROTECTION - GENERAL</b></p> <p>Install a low voltage fail-safe manually operated fire alarm system with 2 call points and 2 bells in each block</p>		x				
<p><b>BUILDING REQUIREMENTS</b></p> <p>Convert area B33 to classroom accommodation of 54.8 m<sup>2</sup></p> <p>Provide by new construction:</p> <p>classroom area totalling 289.2 m<sup>2</sup></p> <p>casualty/sick room of 9 m<sup>2</sup></p> <p>boys' toilets containing 6WCs, 3WHBs</p> <p>girls' toilets containing 8WCs, 4WHBs and one sanitary towel disposal unit</p> <p>Provide one sanitary towel disposal unit in female staff toilet</p>			x			

+

M

## AGREED PHASING OF WORK TO BE COMPLETED BY

	25.5.81	31.3.82	31.3.83	31.3.84	31.3.85	31.3.86
Demolish Blocks A and E Replace Block C before 31 March 1991 to provide classroom area totalling 170 m <sup>2</sup>			x			

M  
J  
T

9

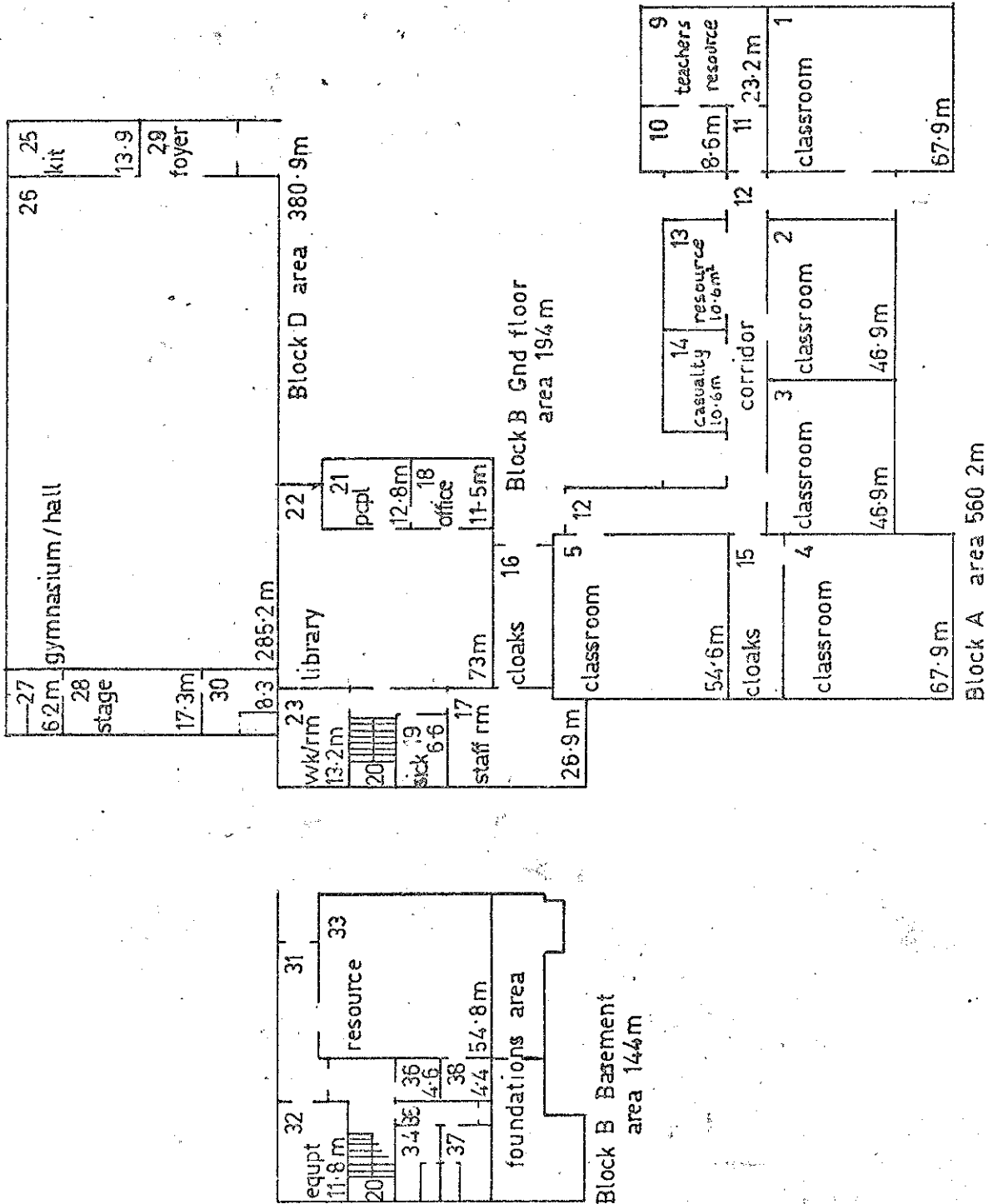

W.F.M.

Drawing No:  
EIP 052 02

Scale:  
1:300

Date:  
20 December 1978

Revision:  
17 MARCH 1981

Drawn:  
R

BUILDINGS DIVISION: INTEGRATION  
SCHOOL: ST JOSEPH'S SCHOOL, ONEHUNGA

+g.m.

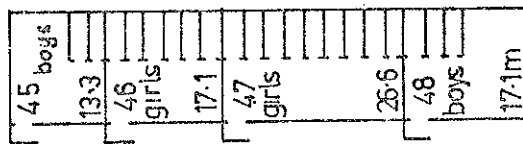
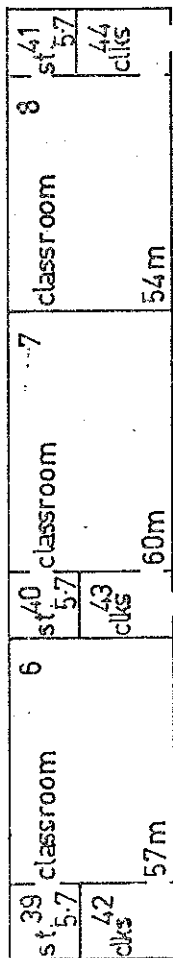

BUILDINGS DIVISION : INTEGRATION  
SCHOOL : ST JOSEPH'S SCHOOL - ONEHUNGA

Drawing No: EIP 052 03	Scale: 1:300
Date: 21 December 1978	
Revision: 17 MARCH 1981	Drawn: R

# FOURTH SCHEDULE.

Schedule of staff appointments to St. Joseph's School, ONEHUNGA under Sections 65(1) & 66 of the Private Schools Conditional Integration Act 1975 being special positions relating to the Special Character of the School

Total Staff Entitlement of School	Principal to be Appointed under S.65 (1) (a) Private Schools Conditional Integration Act 1975	Number of Staff to be so Appointed	Director of Religious Studies to be Appointed under S.65 (1) (b) Private Schools Conditional Integration Act 1975 Scale A or B1 or Higher	Senior Teacher Junior Classes to be Appointed under S.65 (1) (d) Private Schools Conditional Integration Act 1975	Number of Staff to be so Appointed	Religious Instruction Positions of Importance	Number of other teachers to be Appointed under S.65 (1) (c) of Private Schools Conditional Integration Act 1975	Integration Act 1975	Number of Staff to be so Appointed	Deputy Principal to be Appointed under S.66 Private Schools Conditional Integration Act 1975	Number of Staff to be so Appointed
-----------------------------------	---	------------------------------------	---	---	------------------------------------	---	---	----------------------	------------------------------------	--	------------------------------------

Column 1	Column 2	Column 3	Column 4	Column 5	Column 6
1	1	-	-	-	-
2	1	-	-	1	-
3	1	-	-	1	-
4	1	-	-	2	-
5	1	1	-	1	1
6	1	1	-	2	1
7	1	1	1	1	1
8	1	1	1	2	1
9	1	1	1	2	1
10	1	1	1	3	1
11	1	1	1	3	1
12	1	1	1	4	1
13	1	1	1	4	1
14	1	1	1	5	1
15	1	1	1	6	1
16	1	1	1	7	1
17	1	1	1	7	1
18	1	1	1	8	1
19	1	1	1	8	1
20	1	1	1	9	1
21	1	1	1	9	1
22	1	1	1	9	1
23	1	1	1	9	1
24	1	1	1	10	1
25	1	1	1	10	1
26	1	1	1	11	1
27	1	1	1	11	1
28	1	1	1	12	1
29	1	1	1	12	1
30	1	1	1	13	1

NOTES:

- The above Schedule has been prepared for use when the staffing entitlement of the School alters at any time during the currency of this Deed of Agreement to enable the parties hereto by reference to the total staffing entitlement of the School in Column (1) hereof to determine the number of teaching positions at the School which in terms of Section 65 (1) (a), (b), (c) and (d) of the Private Schools Conditional Integration Act 1975 and Clauses 14, 15, 17 and 18 of this Deed carry a responsibility for Religious Instruction and require a willingness and ability to take part in Religious instruction or in terms of Section 66 of the Private Schools Conditional Integration Act 1975 require a particular capability in the teacher as described in Clause 19 of the Deed of Agreement. The Schedule to be read across from left to right.
- Column (5). Section 65 (1) (c) must apply to the number of other positions indicated in the Column and may be made up of teachers appointed under the Initial Appointments Scheme and or other permanent appointments. It is recommended that where the School has a total staffing entitlement of up to eleven there should be at least one appointed as a permanent Scale A Teacher and in schools with a total staffing entitlement of between twelve and fifteen there should be two appointed as permanent Scale A Teachers and in schools with a total staffing entitlement between fifteen and twenty-one there should be at least three appointed as permanent Scale A Teachers.
- The School as at the effective date hereof has a staffing entitlement of Nine (9) teachers