

THIS DEED OF AGREEMENT is made the 4 day of September  
One thousand nine hundred and eighty one  
BETWEEN THE ROMAN CATHOLIC BISHOP OF THE DIOCESE OF  
CHRISTCHURCH a "Corporation Sole" (hereinafter  
with his successors referred to as "the Proprietor")  
of the first part and HER MAJESTY THE QUEEN acting by  
and through the Minister of Education (hereinafter  
referred to as "the Minister") of the second part

WHEREAS

A The Proprietor is the owner of St. Peter's School,  
BECKENHAM.

(hereinafter referred to as "the School")

B The School is a Roman Catholic Primary School for Boys  
and Girls from new entrants to Standard Four offering  
Education with a Special Character.

C The School was established in 1927 and up to the effective  
date of integration was in part staffed by members of the  
Roman Catholic Religious Order of Women, known as the Sisters  
of Our Lady of the Missions. The said Order will continue  
after the effective date of integration to offer teaching  
staff to the school, so long as it has members available  
for that purpose.

D The Minister and the Proprietor have agreed to enter  
into this Deed of Agreement pursuant to the Private  
Schools Conditional Integration Act 1975, whereby the  
School is to be established as an integrated School.

NOW THIS DEED OF AGREEMENT WITNESSETH THAT IT IS HEREBY  
COVENANTED AGREED AND DECLARED BY AND BETWEEN THE PARTIES  
HERETO AS FOLLOWS :-

1. THAT the Minister and Proprietor HEREBY AGREE that  
the School is to become an integrated School pursuant to  
the Private Schools Conditional Integration Act 1975.

*JMA*

*[Signature]*

2. THE School's Special Character as is hereinafter described, shall incorporate the Education with a Special Character as provided in the School AND IT IS HEREBY AGREED AND DECLARED that the School shall at all times in the future be conducted and operated so as to maintain and preserve the School's Special Character and these presents shall be interpreted so as to maintain and preserve the Special Character of the School.

3. ON behalf of the Proprietor it is hereby agreed that:

(a) The Proprietor is the owner of all the land and improvements more particularly described in the First Schedule hereto (hereinafter referred to as "the Proprietor's land") and of which for the purposes of this Deed of Agreement, the School premises form part only. The School premises for the purposes of this Deed of Agreement being the land and improvements more particularly described in the Second Schedule hereto (hereinafter referred to as "the School premises").

(b) The Proprietor shall set apart and appropriate as owner all the School premises and all the chattels and other assets of the Proprietor associated with the School exclusively for the purposes of the School as an integrated School, so that the Controlling Authority of the School shall have the exclusive right to the possession and use of the School premises and chattels

- PROVIDED THAT -

JB PD

- (i) At the request of the Proprietor, the School Committee may grant the use of the School premises and chattels to the Proprietor or other person or persons at any time when the School premises and chattels are not required for school purposes and the School Committee shall not unreasonably or arbitrarily withhold its consent. The School Committee may require the Proprietor or other person or persons to pay a reasonable fee to the School Committee as a condition of such use.
- (ii) With the consent of the Proprietor, the School Committee may grant the use of the School premises and chattels to other person or persons at any time when the School premises and chattels are not required for School purposes and the Proprietor shall not unreasonably or arbitrarily withhold his consent. The School Committee may require any such person or persons to pay a reasonable fee to the School Committee as a condition of such use.
- (c) The Proprietor shall accept and meet the liability for all mortgages, liens and other charges upon the land and buildings comprising the School premises.
- (d) The Proprietor shall plan, pay for, and execute the improvements described in the Third Schedule hereto, to the School premises so as to bring the School buildings and associated facilities forming

HBPD



part of the School premises up to the minimum standard for comparable State Schools prevailing at the effective date of this Deed of Agreement. Such improvements are to be carried out in accordance with the dates specified against such improvements in the Third Schedule hereto. The proprietor shall upon completion of any improvements to electrical services described in the Third Schedule hereto arrange for the local Electrical Supply Authority to inspect the School premises in terms of Regulation 45 of the Electrical Supply Regulations 1976.

- (e) The Proprietor shall plan, execute and pay for such capital works and associated facilities at the School as may be approved or required, from time to time, by the Minister pursuant to Section 40 (2) (d) of the Private Schools Conditional Integration Act 1975.
- (f) The Proprietor may own or hold upon trust, and control and maintain, any land, buildings and associated facilities that, although not part of the integrated School premises in terms of this Deed of Agreement are regarded by the Proprietor as appropriate to maintain the Special Character of the School.
- (g) The Proprietor shall insure all the buildings forming part of the School premises and the Proprietor's chattels (if any) owned or held upon trust for the purposes of the School and the other assets owned by the Proprietor for the purposes of the School against risks

*JBPA*



normally insured against, in some responsible insurance office in New Zealand, and further acknowledges the obligation on him created by Section 40 (2) (h) of the Private Schools Conditional Integration Act 1975.

- (h) No person employed at the School and paid for his services in whole or in part out of moneys appropriated by Parliament, shall be paid by the Proprietor or his servants or agents any remuneration additional to that provided for by the Private Schools Conditional Integration Act 1975 or shall be granted or permitted any condition of service more favourable than that permitted in the case of a person employed in a comparable position in a State School PROVIDED HOWEVER that a teacher to whom the provisions of Section 71 of the Private Schools Conditional Integration Act 1975 apply, shall continue to be paid no less than the same salary, and be accorded the same status, as he received or was accorded on the day before the effective date of the integration of the School.

4. THE land and buildings constituting the School premises are subject to the mortgages, debts, liens, encumbrances, easements, licences, restrictions and other matters which affect the title to or enjoyment of the land and have the appurtenances or benefits attaching to the land more particularly described in the First Schedule hereto.

HBPA



5. THE Special Character of the School is that it is a Roman Catholic School for boys and girls established by the Roman Catholic Bishop of the Diocese of Christchurch, New Zealand, for the Roman Catholic Community of the Diocese of Christchurch, which promotes and supports the School and of which the School is part, to provide and to continue to provide Education with a Special Character, that is to say:

The School is a Roman Catholic School in which the whole School community through the general School programme and in its Religious instructions and observances, exercises the right to live and teach the values of Jesus Christ. These values are as expressed in the Scriptures and in the practices, worship and doctrine of the Roman Catholic Church, as determined from time to time by the Roman Catholic Bishop of the Diocese of Christchurch.

6. THE Proprietor of the School subject to the provisions of this Deed of Agreement :

- (a) Shall continue to have the responsibility to supervise the maintenance and preservation of the Education with a Special Character provided by the School;
- (b) Shall continue to have the right to determine from time to time what is necessary to preserve and safeguard the Special Character of the Education provided by the School and described in this Deed of Agreement;

HBPA



(c) May invoke the powers conferred upon him by the Private Schools Conditional Integration Act 1975, if in the opinion of the Proprietor the Special Character of the School as defined and described in this Deed of Agreement has been or is likely to be jeopardised or the Education with a Special Character provided by the School as defined and described in this Deed of Agreement is no longer preserved and safeguarded.

7. (a) THE Controlling Authority of the School shall be the Education Board of the Canterbury Education District as constituted pursuant to Section 15 of the Education Act 1964.

(b) The School shall be managed by a School Committee constituted pursuant to the provisions of Section 26 of the Private Schools Conditional Integration Act 1975. The School Committee shall consist of :

(i) One (1) member to be appointed by the Proprietor of the School;

(ii) Six (6) members to be elected by the parents of children attending the School PROVIDED HOWEVER that in the event of the School roll altering at any time then the number of such members shall be fixed by ascertaining the number of members that a State School Committee would have, based on the current School roll in accordance with the provi-

*HBMM*



sions of the School Committees Administration Regulations 1965 and subtracting one from that number.

- (c) Any election conducted pursuant to Section 26 of the Private Schools Conditional Integration Act 1975 shall be conducted as nearly as possible in the manner prescribed by the School Committees Administration Regulations 1965 and any regulations made in amendment thereof or in substitution therefor and the provisions of those regulations shall, with any necessary modifications, be applied accordingly.
- (d) The control and management of the School shall be exercised subject to the provisions of Section 25 (6) of the Private Schools Conditional Integration Act 1975.

8. THE School had a roll of one hundred and eight (108) pupils as at the 30th September 1980 being the year when the roll figures were last compiled. It is agreed by and between the parties hereto that the maximum roll of the School shall be one hundred and ten (110) pupils.

9. THE Proprietor agrees that pursuant to Paragraphs (d) and (e) of Clause 3 of this Deed of Agreement he will bring the School up to the minimum standard of accommodation laid down from time to time by the Director-General for a comparable State School.

*16 PM*

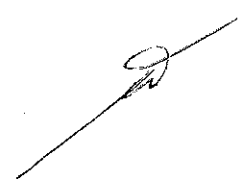



10. (a) PREFERENCE of enrolment at the School under Section 29 (1) of the Private Schools Conditional Integration Act 1975 shall be given only to those children whose parents have established a particular or general religious connection with the Special Character of the School and the Controlling Authority shall not give preference of enrolment to the parents of any child unless the Proprietor has stated that those parents have established such a particular or general religious connection with the Special Character of the School.

(b) In accordance with Section 7 (6) (h) of the Private Schools Conditional Integration Act 1975, unless the Proprietor and the Controlling Authority otherwise agree and subject to places being available, the number of pupils whose parents do not have a preference of enrolment at the School in accordance with the provisions of Section 29 (1) of the Private Schools Conditional Integration Act 1975 shall be limited at all times to six (6) pupils out of the total roll of the School and the Controlling Authority shall not enrol more than that number PROVIDED THAT to maintain and preserve the Special Character of the School the Controlling Authority in classifying such pupils so enrolled shall endeavour to reasonably distribute them through the range of classes offered by the School.

(c) Wherever any difficulty arises related to enrolment at

FBPP

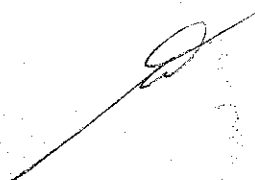

the School in terms of Section 54 of the Private Schools Conditional Integration Act 1975, it may be referred to the Controlling Authority of the School pursuant to the provisions of the said section.

11. IT is agreed by and between the parties hereto that as Religious observances and Religious instruction form part of the Education with a Special Character provided by the School, Religious observances and Religious instruction in accordance with the determination made from time to time by the Roman Catholic Bishop of the Diocese of Christchurch shall continue to form part of the School programme in accordance with Sections 31 and 32 of the Private Schools Conditional Integration Act 1975.

12. THE Proprietor, together with his servants, agents and licensees shall, subject to the proviso to Section 40 (2) (i) of the Private Schools Conditional Integration Act 1975, have at all reasonable times access to the School to ensure that the Special Character of the School is being maintained.

13. THE Proprietor, together with his servants, agents and licensees, shall have at all reasonable times access to the land and buildings of the School constituting the School premises sufficient to enable him to exercise the powers and carry out the responsibilities vested in him and imposed on him by the Private Schools Conditional Integration Act 1975 and by this Deed of Agreement.

HBPA



14. AN advertisement for the position of Principal of the School shall in accordance with Section 65 (1) (a) of the Private Schools Conditional Integration Act 1975 state that a willingness and ability to take part in Religious instruction appropriate to the Special Character of the School shall be a condition of appointment. Any person so appointed to the position of Principal shall accept these requirements as a condition of appointment. The Principal so appointed shall accept and recognise a responsibility to maintain and preserve the Special Character of the School.

15. THERE shall be a position at the School to be designated Director of Religious Studies in accordance with Section 65 (1) (b) of the Private Schools Conditional Integration Act 1975, which position shall be part of the normal staffing entitlement of the School as established by Regulations made under the Education Act 1964 and an advertisement for that position shall state that a willingness and ability to take part in Religious instruction appropriate to the Special Character of the School shall be a condition of appointment. Any person so appointed to the position of Director of Religious Studies shall accept these requirements as a condition of appointment. The Director of Religious Studies shall give guidance and provide effective leadership in Religious instruction and observances throughout the School PROVIDED HOWEVER that in the event of the staffing entitlement of the School altering at any time during the currency of this Deed of Agreement then the position of Director of Religious Studies shall be determined in accordance with the then current staffing entitlement of the School under the Education Act 1964 and Regulations made thereunder and as is more particularly described in the Fourth Schedule hereto.

*ABP*

16. A person appointed as aforesaid to the position of Director of Religious Studies at the School shall undertake such teaching duties, if any, as may be required by the Principal of the School.

17. IN the event of the staffing entitlement of the School altering at any time during the currency of this Deed of Agreement, whereby the School becomes entitled to a position of Senior Teacher Junior Classes, it is agreed pursuant to Section 65 (1)(d) of the Private Schools Conditional Integration Act 1975 that the Controlling Authority of the School in advertising the position of Senior Teacher Junior Classes shall state that a willingness and ability to take part in Religious instruction appropriate to the Special Character of the School shall be a condition of appointment. Any person so appointed to the position of Senior Teacher Junior Classes shall accept these requirements as a condition of appointment.

18. THERE shall be one (1) other teaching position at the School which in accordance with Section 65 (1) (c) of the Private Schools Conditional Integration Act 1975, shall be a position of importance carrying a responsibility for Religious instruction and an advertisement for the position shall state that a willingness and ability to take part in Religious instruction appropriate to the Special Character of the School shall be a condition of appointment. Any person so appointed to this position shall accept these requirements as a condition of appointment PROVIDED HOWEVER that in the event of the staffing entitlement of the School altering at any time during the currency of this Deed of Agreement then the number of teaching positions



*HB*

designated under Section 65 (1) (c) of the Private Schools Conditional Integration Act 1975 as positions of importance carrying a responsibility for Religious instruction shall be determined in accordance with the then current staffing entitlement of the School under the Education Act 1964 and Regulations made thereunder and as is more particularly described in the Fourth Schedule hereto.

19. THE position of Deputy Principal at the School is agreed pursuant to Section 66 of the Private Schools Conditional Integration Act 1975 to be a special position that requires particular capabilities in the teacher appointed, namely to assist in planning and organising the courses and programmes at the School to ensure that they reflect the Special Character of the School and an advertisement for the position of Deputy Principal shall state that possession of these capabilities shall be a condition of appointment. Any person so appointed to the position of Deputy Principal shall accept these requirements as a condition of appointment.

20. THE Proprietor may with the consent of the Controlling Authority in accordance with Section 69 (1) of the Private Schools Conditional Integration Act 1975 arrange for any retired teacher to undertake voluntary tasks to assist in the School with the teaching of Religious observances and Religious instruction appropriate to the Special Character of the School.

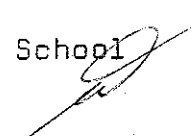
21. IT is agreed by and between the parties hereto that as Religious observances and Religious instruction form part of the Education with a Special Character provided by the School



the Proprietor may employ any person as a Chaplain or otherwise, for the purposes of Religious observances or instruction and the provisions of Section 69 (2) and (3) of the Private Schools Conditional Integration Act 1975 shall apply.

22. THE Proprietor of the School shall have the right to enter into an Agreement with the parents or other persons accepting responsibility for the education of a child providing that, as a condition of enrolment and attendance of that child at the School, the parents or other persons shall pay attendance dues established in respect of the School or group of Integrated Schools owned by the Proprietor or Proprietors of other Roman Catholic Integrated Schools at such rates and subject to such conditions as may be approved from time to time by the Minister, by notice in the New Zealand Gazette in accordance with Section 36 of the Private Schools Conditional Integration Act 1975.

23. THE School is a Primary School for boys and girls from new entrants to standard four and shall remain so until such time as an agreement to a change in this organisation of the School is reached between the Proprietor and the Minister and the parties hereto enter into a supplementary Deed of Agreement to give effect thereto.

24. WHERE any of the costs associated with the conduct of the Proprietor's land that is not part of the School premises cannot be separated from the costs associated with the operation of the School premises, the Proprietor and the school committee and/or the Controlling Authority shall contribute to such costs according to their respective use of the services and facilities.

*HBPA*



25. IT is acknowledged by and between the parties hereto pursuant to Clause 24 hereof that certain of the services and facilities on or serving the Proprietor's land and buildings thereon are used in common for the purpose of the School premises and as is more particularly delineated on the plan forming part of the Second Schedule hereto. In particular the water supply, the power supply, the sewerage and drainage systems and the access way from Fisher Avenue are all used in common and the costs of maintaining such services and facilities shall be apportioned as provided in Clause 24 hereof. If practicable the power supply to the School premises shall be separately metered at the expense of the Proprietor. Where such services or facilities are wholly or partly situated outside the School premises the Proprietor will continue to make such services or facilities available to the School premises.

26. THE Proprietor shall not engage any teachers between the date of execution of this Deed of Agreement and the effective date of integration other than those whose names have already been notified by the Proprietor to the Director-General of Education without first obtaining the consent of the Director-General.

27. THE Proprietor shall reimburse the Minister for the payment of salary, wages and proportion of holiday pay due and paid by the Minister in respect of the 1981 School year to any person employed at the School up to the effective date of Integration.

JBN



28. THE Minister shall subject to Clause 3(d) and (e) of this Deed of Agreement after the effective date hereof maintain the School premises and the associated facilities in a state of repair order and condition as for a comparable State School under the same Controlling Authority and provide for the maintenance of the chattels as though the School were a State School. The School shall be entitled to such furniture and equipment as the Controlling Authority supplies from time to time to comparable State Schools.

29. THE effective date of this Deed of Agreement shall be the 7th day of September, 1981.

30. ON and after the effective date specified in this Deed of Agreement the School shall be an integrated school in terms of the Private Schools Conditional Integration Act 1975.

IN WITNESS WHEREOF these presents have been executed the day and year first hereinbefore written.

*JBPM*

*[Signature]*



SIGNED by BRIAN PATRICK ASHBY

THE ROMAN CATHOLIC BISHOP OF

THE DIOCESE OF CHRISTCHURCH

and sealed with his Seal of

Office in the presence of :-

*Anne C. McElven*  
*Secretary*  
*Christchurch*

*+ B. P. Ashby*

SIGNED FOR AND ON BEHALF OF HER MAJESTY

THE QUEEN by MERVYN LANGLOIS WELLINGTON

Minister of Education in the presence of:-

*M. J. Folker*  
*(Private Secretary)*

*12 Hokina Road*

*Hataitai*

*Wellington, 3.*

*Mervyn Langlois*

FIRST SCHEDULE

Description of total land buildings and other improvements comprising the Proprietor's lands of which the School premises form part.

THE PROPRIETOR'S LAND

All that land, school buildings, hall, church, presbytery and convent and other improvements owned by the Roman Catholic Bishop of the Diocese of Christchurch situated at 9 Fisher Avenue, Christchurch delineated in green on the annexed plan known as St. Peter's School, and St. Peter's Catholic Church and Presbytery and being more particularly described as:

FIRSTLY all that freehold parcel of land containing 7188 square metres more or less situated in Christchurch Survey District being Lot 1 on Deposited Plan 25964 part of rural section 49 and being all that land in Certificate of Title Volume 7D Folio 1457 (Christchurch Registry).

SECONDLY all that freehold parcel of land containing 321 square metres more or less situated in Christchurch Survey District being Lot 6 on Deposited Plan 2461 part of rural section 49 and being all that land in Certificate of Title Volume 7A Folio 911 (Christchurch Registry).

THIRDLY all that freehold parcel of land containing 981 square metres more or less situated in Christchurch Survey District being Lot 6 on Deposited Plan 2461 part of rural section 49 and being all that land in Certificate of Title Volume 326 Folio 30 (Christchurch Registry).

FOURTHLY all that freehold parcel of land containing 3670 square metres more or less situated in the Christchurch Survey District being Lots 6,7, 14 and 15 on Deposited Plan 1361 part of rural section 49 and being all that land in Certificate of Title Volume 365 Folio 52 (Christchurch Registry), subject to

- (1) Transfer 171527 Granting an Easement appurtenant to the above land
- (2) Transfer 443658 Grant of Stormwater Easement over part Lot 8 DP 1361 (part CT 496/83) appurtenant to the above described land.

LB PM





SECOND SCHEDULE

Description of land, buildings and other improvements comprising the school premises.

THE SCHOOL PREMISES

All that part of the Proprietor's land as described in the First Schedule hereto, delineated in red on the annexed plan of the Proprietor's land which plan forms part of this Schedule together with all school buildings and other improvements thereon, AND with a right in common with the Proprietor his agents servants and licensees to the use of the area shaded Yellow on the said plan for ingress and egress from and to Fisher Avenue Christchurch by persons lawfully attending the school premises.



# THIRD SCHEDULE

ST PETER'S SCHOOL, BECKENHAM, CHRISTCHURCH

WORKS TO BE CARRIED OUT BY THE PROPRIETOR IN RELATION TO THE INTEGRATED SCHOOL

These works are to be planned, executed and paid for by the proprietor subject to the provisions of this schedule in relation to the buildings and associated facilities to bring them up to the minimum standard for a comparable state school. All work is to be carried out by competent tradesmen or in a workmanlike manner to the Canterbury Education Board standards.

AGREED PHASING OF WORK TO BE COMPLETED BY						
SITE	7.9.81	31.3.82	31.3.83	31.3.84	31.3.85	31.3.86
Renail west boundary iron fence						
Replace all broken palings in fences on north and east boundaries		x				
		x				
BLOCK A						
Exterior						
Paint exterior						
Ease all doors and opening windows		x				
Replace facing to door frame of the door area 5		x				
Check all door and window furniture and replace as required		x				
Replace all rotten and borer infested weather-boards		x				
Replace rotten caps and barges		x				
Replace missing foundation vents		x				
Replace all broken glass		x				
Clean out all spouting and downpipes		x				
Secure loose downpipes		x				
Interior						
Areas 3 and 4						
Clean woodwork and paint						

*Handwritten initials*

*Handwritten signature*

ABD

	7.9.81	31.3.82	31.3.83	31.3.84	31.3.85	31.3.86
Interior (continued) BLOCK A						
All areas						
Completely repaint - half cost to be met by Education Board						
Electrical						
Provide security lighting to Block B (Area 6) and Block A (Area 1)						
Replace broken glass on security light fitting outside area 5		x				
Replace switch socket units in areas 2, 3 and 4		x				
Remove redundant light switch and wiring, area 3		x				
Renew lighting installation, areas 2, 3 and 4		x				
Upgrade heating to state standards, areas 2, 3 and 4		x				
Area 2						
Install one additional wall plug socket to state standards						
Area 4						
Install two additional wall plug sockets to state standards						
FIRE PROTECTION						
Area 1						
Remove materials blocking alternative egress	x					
Repair door and provide and fit half latch furniture not requiring keys	x					
Area 2						
Fit a 1-hour rated fire partition extending from floor to roof between this space and the adjoining hall						

x

x x x x x x

x

x

x

J. B. M.

	7.9.81	31.3.82	31.3.83	31.3.84	31.3.85	31.3.86
<u>BLOCK A (continued)</u>						
Fix panel type electric heater to the wall	x					
<u>Area 3</u>						
Replace dead lock in alternative egress door with half latch furniture not requiring key	x					
Permanently secure cabinet type portable electric heater or withdraw	x					
<u>Area 4</u>						
Remove dead lock from egress door via area 3	x					
<u>Area 5</u>						
Remove BCF extinguisher and replace with a 9 litre water extinguisher					x	
Install two instructional marker plates for gas/water extinguishers	x					
<u>BLOCK B</u>						
<u>Exterior</u>						
Replace deteriorated weatherboards					x	
Replace rotten caps					x	
Replace missing foundation vents					x	
Replace broken glass					x	
Clean out all spouting and downpipes					x	
Replace rusty spouting south wall					x	
Repair two sashes					x	
Ease all doors and opening windows					x	
Check over all door and window furniture and make good					x	
<u>Area 6</u>						
Replace fabric roof and repair junction with gutter, repair ceiling						x

*1300*

	7.9.81	31.3.82	31.3.83	31.3.84	31.3.85	31.3.86
Area 6 Contd. Replace rotten timbers east end Replace galvanised iron drinking fountain with stainless steel to comply with health regulations Paint exterior when work completed		x				
Interior		x x				
Areas 8 and 16						
Replace wooden wc seats with approved type		x				
Area 11						
Replace sink and bench top Repair roof and paint ceiling		x x				
All areas Completely repaint - half cost to be met by Education Board						
Structural						
Wire down tiles on roof Provide additional bracing in the plane of the roof		x x				
Electrical						
Renew VIR submains in casing Replace original wiring		x x				
Areas 9, 10, 11 and 14						
Upgrade lighting to state school standards Upgrade heating to state school standards Remove portable heaters	x	x x				
Area 9 and 14						
Install one additional wall plug socket in each to Education Board requirements		x				

1 Bm

	7.9.81	31.3.82	31.3.83	31.3.84	31.3.85	31.3.86
FIRE PROTECTION						
<u>Areas 9 and 11</u>						
Permanently secure cabinet type electric heater or remove	x					
<u>Area 10</u>						
Remove BCF extinguisher		x				
<u>Area 11</u>						
Remove kerosene heater and 18 litre can of methylated spirits	x					
<u>Areas 9 and 14</u>						
Install one instructional marker plate for gas/water extinguisher in each area				x		
<u>BLOCK F</u>						
<u>Structural</u>						
Upgrade as may be required when extent of reinforcement known				x		
<u>Electrical</u>						
<u>Area 23</u>						
Permanently wire filtration plant pump motor				x		
Paint				x		



JB PP

Electrical - General	7.9.81	31.3.82	31.3.83	31.3.84	31.3.85	31.3.86
Upgrade existing mains power supply to school for additional loading Install check meter on switchboard Block A to separately meter supply to non-integrating areas Upgrade overhead line between Blocks A and B	x	x	x			
FIRE PROTECTION - GENERAL						
Install a low voltage manually operated fail safe fire alarm system with call points and bells located in each of the following areas:	x					
Block A Area 5						
Block B Area 6 (outside Area 10)						
BUILDING REQUIREMENTS						
Provide the following facilities by remodelling or new construction						
Casualty/sickroom of 9m <sup>2</sup>						
One staff toilet containing one wc pan, one whb						
One sanitary towel disposal unit in female staff toilet						
SAFETY REQUIREMENTS in areas not acceptable for integration						
BLOCK H						
Fire Protection						
Fit conventional panic bolt hardware to egress doors						
Install an emergency lighting system in the hall complex	x					
Provide and erect exit signs over egress doors	x					
Install and link fire alarm system to adjoining Block A	x					
Upgrade dividing wall between Blocks H and A to provide 1 hour fire rated surface	x					

*1300*

Block H Contd

Arrange for initial and regular servicing  
of the water type fire extinguisher installed

x

7.9.81	31.3.82	31.3.83	31.3.84	31.3.85	31.3.86

*[Signature]*

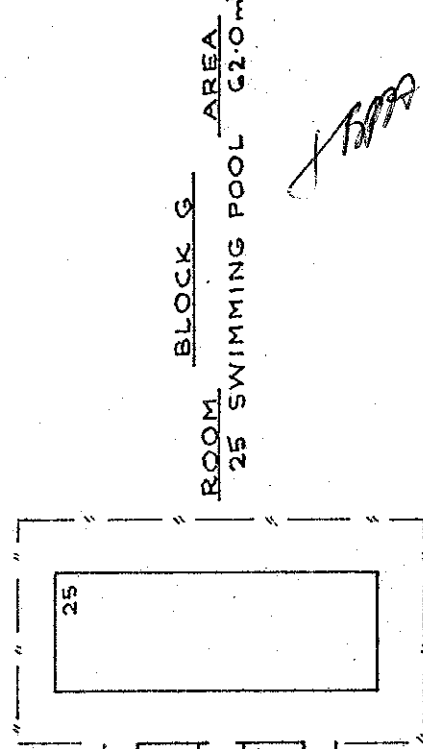
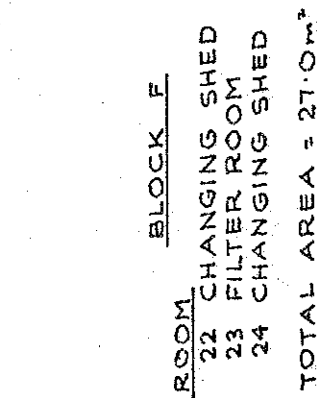
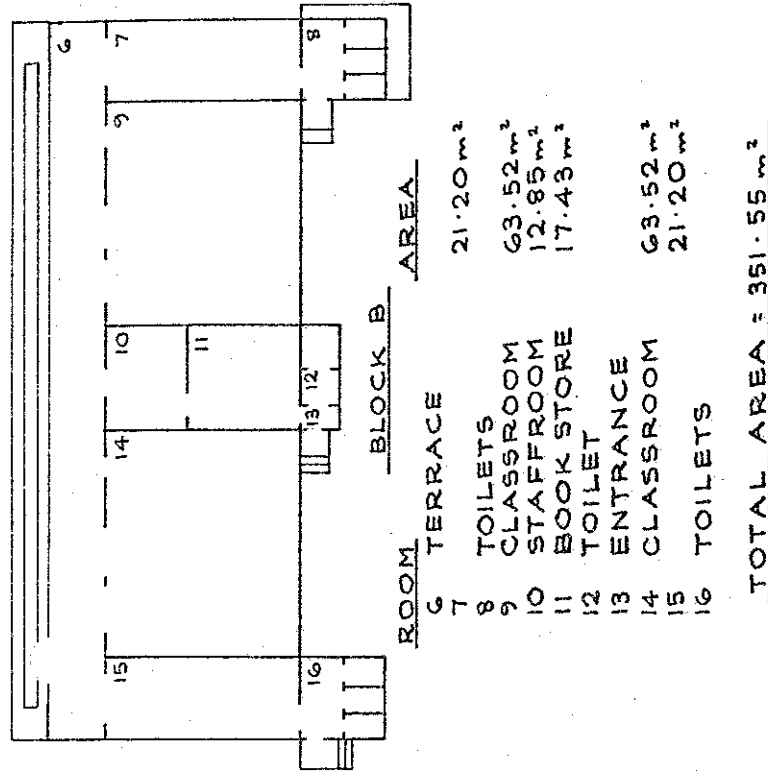
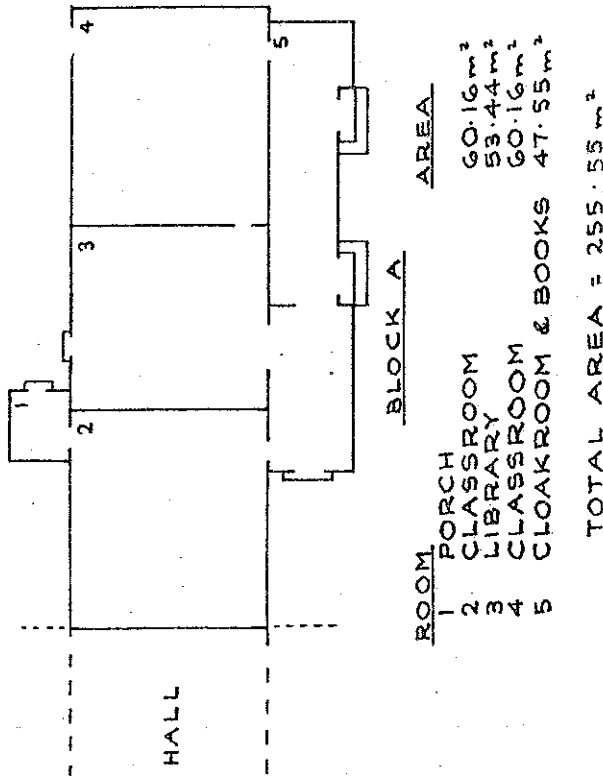

DEPARTMENT OF EDUCATION  
buildings division: integration of private schools  
School: ST PETER'S SCHOOL, BECKENHAM

Drawing No:	Scale:
EIP 144 02	1:300
Date:	SHEET 2 OF 2 SHEETS
29 MAY 1980	Drawn: LEB
Revision	

# FOURTH SCHEDULE.

Schedule of staff appointments to St. Peter's School, BECKENHAM under Sections 65(1) & 66 of the Private Schools Conditional Integration Act 1975 being special positions relating to the Special Character of the School

Total Staff Entitlement of School	Principal to be Appointed under S.65 (1) (a) Private Schools Conditional Integration Act 1975	Number of Staff to be so Appointed	Director of Religious Studies to be Appointed under S.65 (1) (b) Private Schools Conditional Integration Act 1975 Scale A or B1 or Higher	Senior Teacher Junior Classes to be Appointed under S.65 (1) (d) Private Schools Conditional Integration Act 1975	Number of Staff to be so Appointed	Religious Instruction Positions of Importance Number of other teachers to be Appointed under S.65 (1) (c) of Private Schools Conditional Integration Act 1975	Number of Staff to be so Appointed (See Footnote No. 2 to this Schedule)	Deputy Principal to be Appointed under S.66 Private Schools Conditional Integration Act 1975 Number of Staff to be so Appointed
-----------------------------------	---	------------------------------------	---	---	------------------------------------	---	--	---

Column 1	Column 2	Column 3	Column 4	Column 5	Column 6
1	1	-	-	-	-
2	1	-	-	1	-
3	1	-	-	1	-
4	1	-	-	2	-
5	1	1	-	1	1
6	1	1	-	2	1
7	1	1	1	1	1
8	1	1	1	2	1
9	1	1	1	2	1
10	1	1	1	3	1
11	1	1	1	3	1
12	1	1	1	4	1
13	1	1	1	4	1
14	1	1	1	5	1
15	1	1	1	6	1
16	1	1	1	7	1
17	1	1	1	7	1
18	1	1	1	7	1
19	1	1	1	8	1
20	1	1	1	8	1
21	1	1	1	9	1
22	1	1	1	9	1
23	1	1	1	10	1
24	1	1	1	10	1
25	1	1	1	11	1
26	1	1	1	11	1
27	1	1	1	12	1
28	1	1	1	12	1
29	1	1	1	12	1
30	1	1	1	13	1

## NOTES:

- The above Schedule has been prepared for use when the staffing entitlement of the School alters at any time during the currency of this Deed of Agreement to enable the parties hereto by reference to the total staffing entitlement of the School in Column (1), hereof to determine the number of teaching positions at the School which in terms of Section 65 (1) (a), (b), (c) and (d) of the Private Schools Conditional Integration Act 1975 and Clauses 14, 15, 17 and 18 of this Deed carry a responsibility for Religious Instruction and require a willingness and ability to take part in Religious Instruction or in terms of Section 66 of the Private Schools Conditional Integration Act 1975 require a particular capability in the teacher as described in Clause 19 of the Deed of Agreement. The Schedule to be read across from left to right.
- Column (5). Section 65 (1) (c) must apply to the number of other positions indicated in the Column and may be made up of teachers appointed under the Initial Appointments Scheme and or other permanent appointments. It is recommended that where the School has a total staffing entitlement of up to eleven there should be at least one appointed as a permanent Scale A Teacher and in schools with a total staffing entitlement of between twelve and fifteen there should be two appointed as permanent Scale A Teachers and in schools with a total staffing entitlement of between fifteen and twenty-one there should be at least three appointed as permanent Scale A Teachers.
- The School as at the effective date hereof has a staffing entitlement of FIVE (5) teachers

*J. B. 1977*